

**IHSAA Cross Country Greensburg Regional Championship**  
**Saturday, October 15, 2011**  
at  
**Greensburg High School**  
**1000 East Central, Greensburg, IN 47240**

**“Train Kept a Rollin’ ” – by Aerosmith**  
(a DJ Rob selection)

With a third place finish for both the boys and the girls in the Sectional, it’s time for the FCOMM train to keep rollin’ to the next step of the tournament, the Regional meet to be contested at Greensburg High School. The top five teams and 15 individuals from these races will advance to the Carmel Semi-State next Saturday.

This is not a favorite course of the tent boys. It’s a flat, two-loop racetrack around the school grounds with wonderful obstacles such as pavement crossings, curbs, fire hydrants and fence posts for runners to contend with. Besides that, it has an odd meteorological sub-climate that generates strange wind microbursts that wreak havoc on otherwise wonderful tent set-ups. With tomorrow’s forecast for 20 mph winds, things might get interesting.

**2011 Meet Schedule**

**10:30 a.m.      Boys Varsity Race**  
**11:15 a.m.      Girls Varsity Race**  
**12:00 noon      Awards**

**Scoring**

The top 15 individuals in each race and the first 5 qualifying teams will advance to the Carmel Semi-state. Results will be available on [www.alphatiming.net](http://www.alphatiming.net)

**Participating Teams:**

See the tables over the next several pages for teams participating in all the Regional Championships that feed into the Carmel Semi-State meet. The times for all runners in the two Sectional meets feeding the Greensburg Regional are included.

**2010 Results:**

Girls		Boys	
1 Columbus North	18	1 Columbus North	18
2 Center Grove	56	2 Center Grove	56
3 Oldenberg	110	<b>3 Franklin Comm</b>	<b>131</b>
<b>4 Franklin Comm</b>	<b>114</b>	4 Columbus East	133
5 Whiteland	132	5 South Dearborn	148
6 Batesville	176	6 Greenwood	152
7 Columbus East	181	7 Batesville	187
8 East Central	216	8 East Central	192
9 South Dearborn	260	9 Franklin County	195
10 North Decatur	273	10 South Ripley	282

## Down the Tournament Road

Tonight's sectional is one of 32 sectionals that feed into 16 regional meets, that then feed into 4 semi-state meets (New Prairie, New Haven, Carmel, Brown County). At the sectional and regional level, the top 5 teams and top 15 individuals (whether on a top 5 team or not) advance to the next level. The top 6 teams, and top 15 individuals from each semi-state advance to the state meet to establish the field of 24 teams to compete in Terre Haute for the state title. FCOMMs path to the State meet:

Semi-State (Carmel)	Saturday, October 22 <sup>nd</sup> , at Northview Christian Life Church, Carmel, IN Field consists of 5 teams each from Brebeuf, Ben Davis, Connersville and Greensburg Regionals
State Finals	Saturday, October 39 <sup>th</sup> , LaVern Gibson Cross Country Course (Girls 1:00 p.m., Boys 1:45 p.m.)

### Carmel Semi-State Round-up (Following Sectionals)

These regionals and sectionals feed into the Carmel Central Semi-State. Teams are listed in the order of their finish at sectionals. Complete sectional results can be found at [www.ihcaa.org](http://www.ihcaa.org) (under Sports>Cross Country>2011-2012> State Tournament). **Ranked teams are shown in bold.**

<b>Greensburg Regional</b>		
<b>Franklin Sectional</b>	<b>Boys</b>	<b>Girls</b>
	<b>Columbus North - 15</b> (15:46, 15:55, 16:00, 16:03, 16:06, 16:31, 17:11)	<b>Columbus North - 21</b> (18:26, 19:03, 19:11, 19:30, 19:48, 20:07)
	<b>Center Grove - 79</b> (16:33, 16:48, 17:00, 17:01, 17:03, 17:14, 17:16)	<b>Center Grove - 57</b> (19:19, 19:45, 19:53, 20:20, 21:07, 21:13, 22:43)
	Franklin Community - 106 (16:43, 16:45, 17:23, 17:30, 17:31, 17:52, 18:16)	Franklin Community - 75 (19:35, 19:40, 20:45, 21:49, 21:58, 22:03, 22:35)
	Indian Creek - 17 (16:25, 16:32, 17:45, 17:50, 17:51, 19:22, 19:50)	Whiteland - 95 (19:39, 20:21, 20:55, 22:23, 23:04, 24:19, 24:49)
	Greenwood - 120 (16:21, 16:43, 17:35, 17:50, 18:10, 18:47, 20:13)	Columbus East - 144 (21:25, 22:04, 22:47, 23:45, 23:57, 26:27)
<b>South Dearborn Sectional</b>		
	South Dearborn - 45 (17:00, 17:53, 17:56, 18:05, 18:33, 19:02, 20:09)	<b>Oldenburg Academy - 47</b> (20:12, 20:18, 20:37, 20:56, 24:39, 30:25, 31:02)
	East Central - 63 (17:38, 17:39, 18:15, 18:36, 19:10, 19:29, 19:30)	Lawrenceburg - 59 (21:26, 22:03, 22:35, 22:54, 23:19, 28:08, 35:13)
	Batesville - 91 (17:27, 17:43, 18:58, 19:18, 19:33, 19:59, 22:06)	Batesville - 107 (22:22, 23:00, 23:53, 23:55, 24:14, 25:37, 25:48)
	South Ripley - 99 (18:00, 18:10, 18:40, 19:24, 19:25, 20:24, 20:46)	Jac-Cen-Del - 117 (22:26, 22:50, 23:59, 24:15, 24:23, 24:43, 25:57)
	Rising Sun - 102 (17:38, 18:26, 18:56, 19:14, 19:39, 19:41, 21:03)	East Central - 117 (21:09, 23:03, 23:10, 24:25, 24:57, 25:13, 26:42)

<b>Indianapolis Brebeuf Regional</b>		
<b>Indianapolis Brebeuf Sectional</b>	Boys	Girls
	<b>North Central – 40</b>	<b>North Central – 37</b>
	<b>Lawrence Central – 43</b>	<b>Indianapolis Bishop Chatard – 47</b>
	<b>Brebeuf Jesuit – 78</b>	Indianapolis Cathedral - 80
	Cathedral – 87	Lawrence Central – 96
	Lawrence North – 97	Brebeuf Jesuit – 99
<b>Noblesville Sectional</b>		
	<b>Carmel - 44</b>	<b>Carmel - 26</b>
	<b>Hamilton Southeastern – 47</b>	<b>Hamilton Southeastern – 68</b>
	<b>Zionsville - 91</b>	<b>Noblesville - 70</b>
	<b>Westfield – 102</b>	<b>Westfield - 90</b>
	Guerin Catholic – 127	<b>Fishers - 137</b>

<b>Ben Davis Regional</b>		
<b>Ben Davis Sectional</b>	Boys	Girls
	<b>Ben Davis – 32</b>	Pike – 29
	Perry Meridian – 58	Perry Meridian – 44
	Pike – 71	Ben Davis – 55
	Southport – 109	Indianapolis Cardinal Ritter – 116
	Speedway - 156	Southport – 131
<b>South Putnam Sectional</b>		
	<b>Avon – 47</b>	<b>Avon – 23</b>
	<b>Brownsburg - 50</b>	Brownsburg - 59
	Greencastle – 66	Greencastle - 99
	Cascade – 100	Plainfield - 100
	Plainfield - 102	Tri-West – 158

<b>Rushville Regional</b>		
<b>Connersville Sectional</b>	Boys	Girls
	New Castle Chrysler – 69	Hagerstown - 51
	Northeastern - 73	Connersville - 53
	Rushville – 80	Union County - 91
	Connersville - 103	Richmond – 117
	Union County - 125	New Castle Chrysler - 134
<b>New Palestine Sectional</b>		
	<b>Franklin Central - 27</b>	<b>Franklin Central - 17</b>
	Warren Central - 57	Warren Central - 68
	Greenfield-Central - 97	New Palestine - 81
	Roncalli - 99	Roncalli – 118
	New Palestine - 148	Greenfield-Central - 148

State Rankings:

The final state rankings by Indianarunner.com. Teams that have to pass through the Carmel Semi-State are shown in bold. Teams from the Carmel Semi-State that did not advance from the previous round are shown in red.

Rank	Boys	Girls
1	<b>Carmel</b>	<b>Carmel</b>
2	<b>Columbus North</b>	<b>Columbus North</b>
3	<b>Hamilton Southeastern</b>	<b>Franklin Central</b>
4	Bloomington South	West Lafayette
5	<b>Zionsville</b>	<b>Westfield</b>
6	<b>North Central</b>	<b>Hamilton Southeastern</b>
7	Mishawaka	<b>Avon</b>
8	<b>Franklin Central</b>	<b>Center Grove</b>
9	<b>Lawrence Central</b>	<b>Noblesville</b>
10	Valparaiso	Fort Wayne Carroll
11	South Bend St. Joseph's	Fort Wayne Concordia
12	<b>Westfield</b>	Terre Haute North
13	Fort Wayne Carroll	<b>North Central</b>
14	Homestead	Penn
15	<b>Brebeuf</b>	Warsaw
16	North Harrison	<b>Fishers</b>
17	LaPorte	Valparaiso
18	Warsaw	<b>Zionsville</b>
19	Fort Wayne Snider	Northridge
20	<b>Brownsburg</b>	Evansville Memorial
21	Bedford North Lawrence	<b>Bishop Chatard</b>
22	<b>Avon</b>	Eastern (Greentown)
23	<b>Center Grove</b>	Huntington North
24	<b>Fishers</b>	Crown Point
25	<b>Ben Davis</b>	<b>Oldenburg Academy</b>

### Directions

You can get to I-74 either by taking I-65 north to I-465 East to I-74 South, or you can take SR-44 from Franklin through Shelbyville to 74. Greensburg is 20 miles past Shelbyville. The most direct route from Franklin is to take SR-44, however there is some road construction that you need to consider in Shelbyville. SR-44. Instead of taking SR-44 through Shelbyville, at the four-way stop on the west side of Shelbyville (just west of the high school) continue straight past the high school (SR-44 turns left, don't go that way). Follow this road to the fourth stop sign and turn left on Progress Parkway (north). At the second stop light turn right on SR-44 and then take a right on to the entrance ramp to I-74 South.

There are two interchanges from Greensburg off of I-74. Take the second exit (Exit 134A) and turn left at the first stop light on Freeland Road. Follow Freeland Road until you reach a stop sign and no outlet sign. This is Montgomery Road. Turn right on Montgomery Road and follow this (curvy road) for about 1.3 miles. Go through the four-way stop and continue on until you see the school on the left. Turn on the road (not marked) that runs between the soccer fields. This is Big Blue Road. Turn into the parking lot on your left and drive to the other end, as close to the tennis courts as possible. If they have this lot/road blocked off you can park in the lot next to the football field. There is another parking lot on the other side of the school but it is much smaller and farther from the start/finish line.

The start/finish lines are on the other side of the tennis courts. It should take approximately 1 hour and 15 minutes from Franklin to the course.

### The Course and Viewing Suggestions

This course is essentially two laps around the Greensburg School grounds, including numerous pavement crossings and curbs. Although runners are always within 500 meters of the school, buildings, bleachers and chain link fences often obscure your view. You can stand near the start line and see the runners pass on the start, between the 1K and 2K, between the 2K and 3K, between the 4K and 5K, and then the finish.

If you stand south of the baseball diamond and east of the tennis courts (the red surface in the photo) you can get a good view of the start including the fight to get through the narrow gate just west of the finish line. You can then walk a short distance straight south to see the runners go south and turn west to go behind the south end of the school building.

You have to run to the east side of the south parking lot to see the early race develop south of the school building. As the runners go east along the south edge of the parking lot they take a 45 degree turn as they step off the curb onto the paved driveway. This area in the past has been very poorly marked with spectators standing in the middle of the course as the runners approached the turn. The course then follows a northeasterly diagonal across the grass to return to the east side of the tennis courts and a turn west to loop around the athletic fields to the north. If you run to the west of the tennis courts and to the north you can view the runners winding their way through the athletic fields. The runners then return past the start line and repeat a second lap to the finish chute that is due east of the southeast corner of the tennis courts (immediately adjacent to the baseball diamond).

You can only view the finish by standing west of the relatively short finishing straightaway.

# AREA MAP



# DETAIL MAP



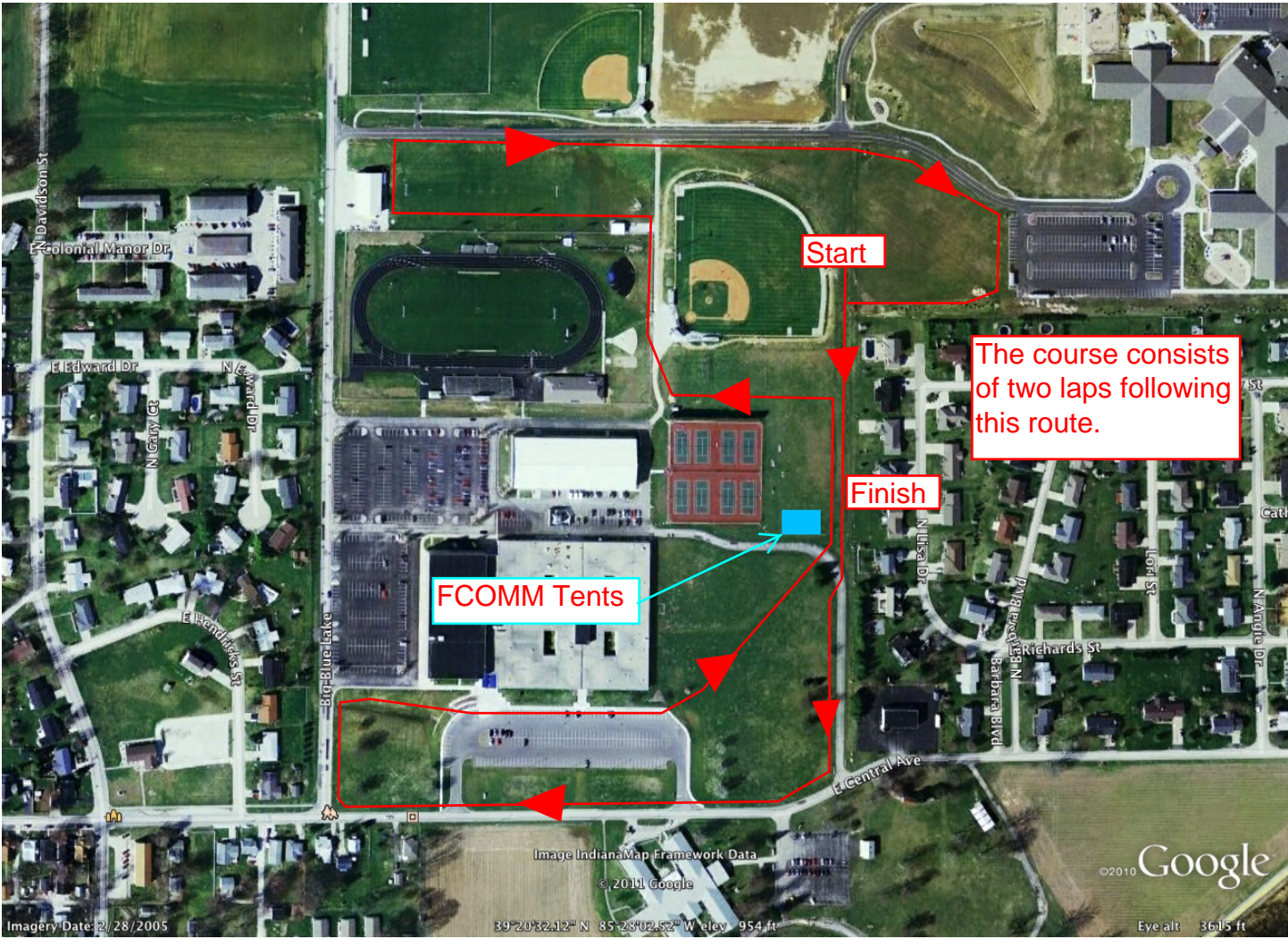

Start

The course consists of two laps following this route.

Finish

FCOMM Tents

Google

Image IndianaMap Framework Data

© 2011 Google

Imagery Date: 2/28/2005

39°20'32.12" N 85°23'02.32" W elev 954 ft

Eye alt 3615 ft



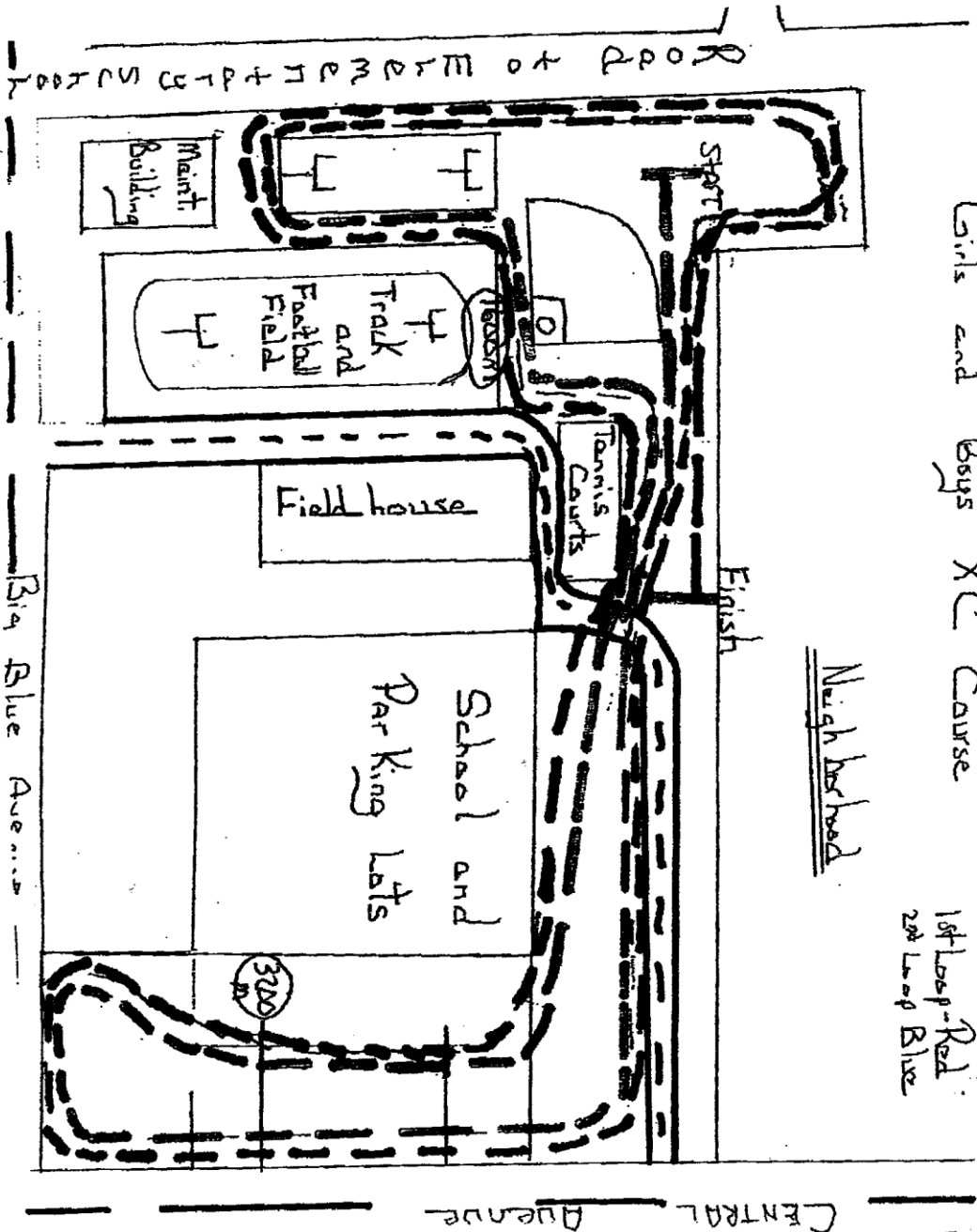

Girls and Boys XC Course

Neighborhood

1st Loop - Red  
2nd Loop - Blue

CENTRAL Avenue

Big Blue Avenue

Road to W... + ...